

# SMART SOCKET 90mm



Part Number: **25657**



## LIGHTER **FASTER** STRONGER

RAD Smart Sockets™ use RAD Torque's transducer technology combined with a socket to measure torque applied to the bolt. Its a perfect audit tool for inspecting bolted joints and a master calibration for torque tools.

### SPECIFICATIONS

Torque Ranges: 800 ft. lbs. - 12000 ft. lbs.  
Weight: 12.8 lbs.  
Square Drive: 1.5"  
Repeatability: +/-1  
Accuracy: +/-1%

### DIMENSIONS

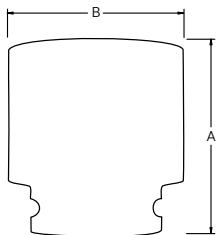

DIMENSION A	DIMENSION B
4.95"	6.16"

### Included Storage Case

Weatherproof. Comes with Plug & USB cord.



Bluetooth connectivity to your smart phone or tablet



Non Impacting



Safe & Reliable



Class 1 Division 2 Group A, B, C, D T4



Accredited ISO/IEC 17025



Accredited ISO/IEC 17025



## NEW WORLD TECHNOLOGIES INC

#100 - 30722 MARSHALL RD | ABBOTSFORD, BC V2T 0H9 | CANADA  
604.852.0405 | INFO@RADTORQUE.COM | RADTORQUE.COM